



AGENDA
ATHENS SHADE TREE COMMISSION
WEDNESDAY, APRIL 15th, 2026 AT 6:00 PM

Streaming is available at www.ci.athens.oh.us/video

- 1. Establish Quorum**
- 2. Disposition of Minutes**
 - March 18th, 2026
- 3. Title 33: Tree Permit, Right of Way Issues, Public Land**
 - Carpenter St utility work plans and trees
- 4. Title 37: Landscape Ordinance Issues**
- 5. Maintenance of the Tree Canopy**
- 6. New Business**
- 7. Old Business**
 - Bioblitz
 - Subcommittees
 - Overhaul of recommended tree list
- 8. Announcements & Other Business**
 - Next meeting: May 20th, 2026
- 9. Adjournment**

The City of Athens supports the Americans with Disabilities Act. Requests for reasonable accommodation may be made with the ADA Coordinator in the City Building or by calling 592-3367.

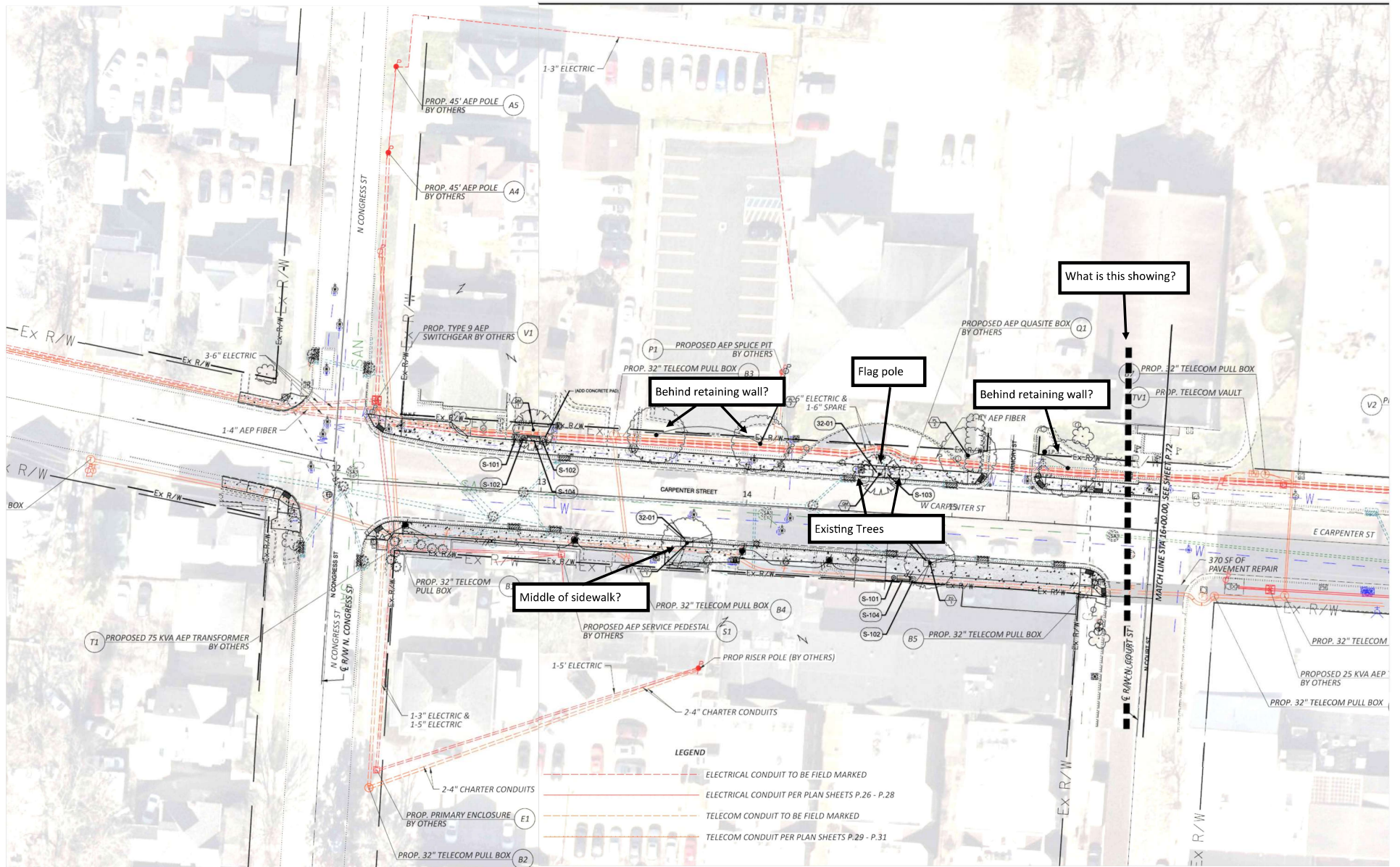

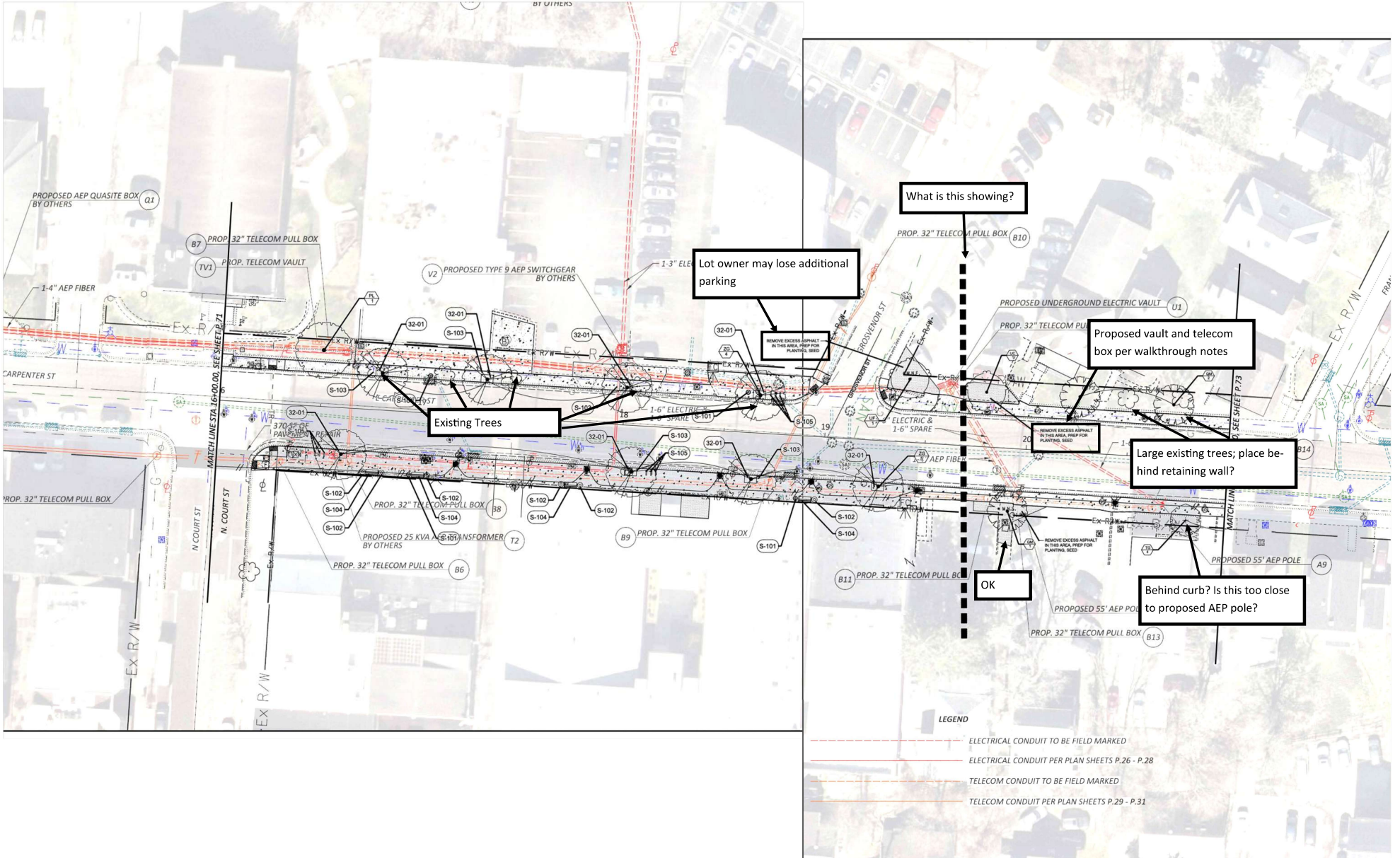

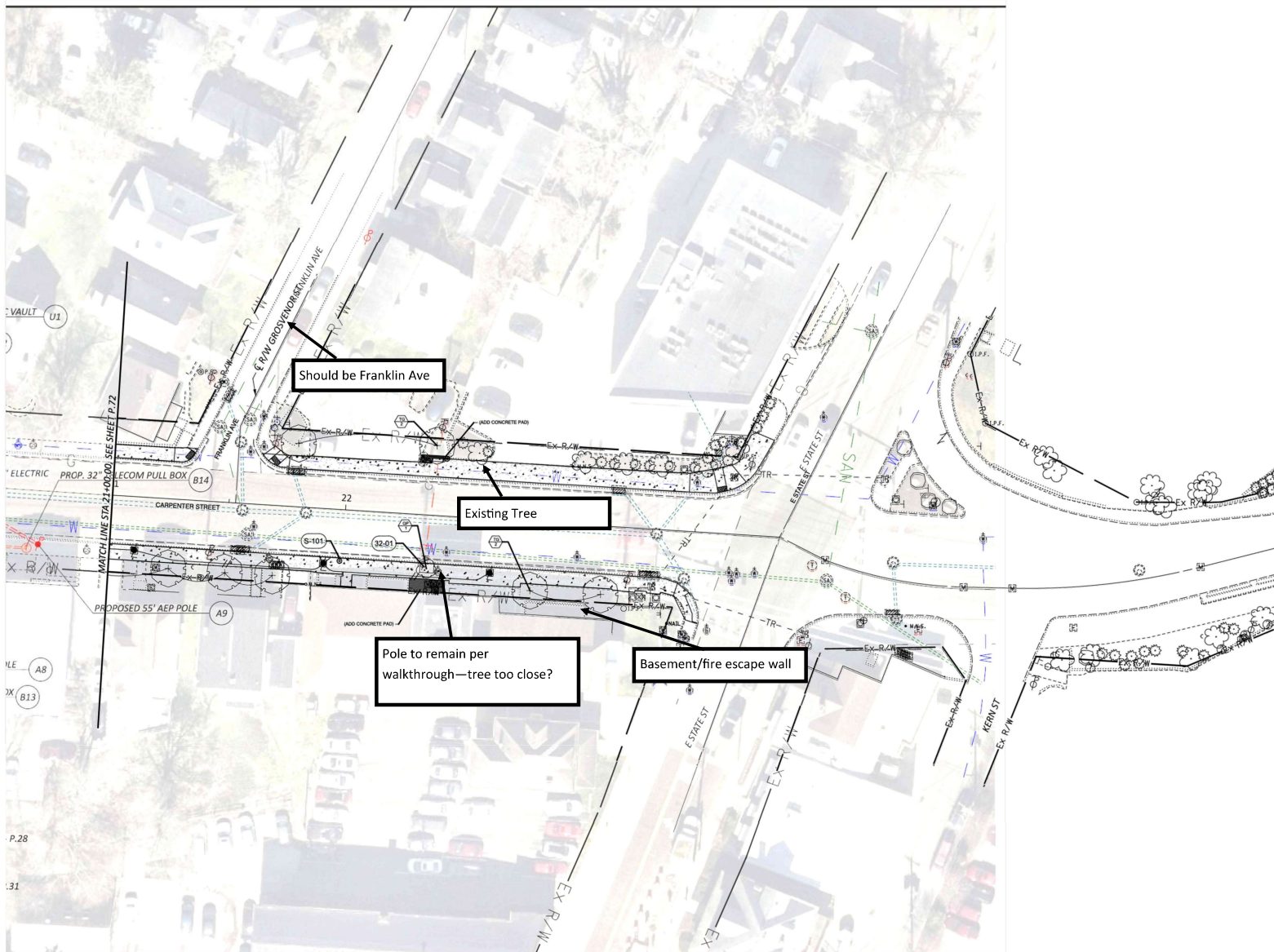

Should be Franklin Ave

Existing Tree

Pole to remain per
walkthrough—tree too close?

Basement/fire escape wall

SITE FURNISHINGS (SEE TAG NOTES FOR COLOR/STYLE, ETC)



BENCH



CURVED BENCH



TRASH RECEPTACLE



BIKE RACK



PLANTER

No recycling? Existing receptacles?

SITE FURNISHINGS SCHEDULE

CODE	DESCRIPTION
S-101	TRASH RECEPTACLE, VICTOR STANLEY, S-42, COLOR: (GREEN/HERITAGE GREEN; CONTRACTOR TO MATCH W. UNION STREET FURNISHINGS), TO MATCH FURNISHINGS ON W. UNION ST., LOCATE AS INDICATED, SURFACE MOUNT PER MANUFACTURERS RECOMMENDATION
S-102	PLANTER, CRP-VS, BELSON OUTDOORS CARNIVAL COLLECTION STEEL ROUND PLANTER, WITH TOP RING, COLOR: (GREEN/FOREST GREEN/EMERALD GREEN; CONTRACTOR TO MATCH W. UNION STREET FURNISHINGS), TO MATCH FURNISHINGS ON W. UNION ST., LOCATE AS INDICATED, SURFACE MOUNT PER MANUFACTURERS RECOMMENDATION
S-103	CURVED BENCH, PCS-72-180, BELSON OUTDOORS PREMIER STYLE CIRCULAR TREE BENCH WITH BACK, (COLOR: MOSS GREEN, CONTRACTOR TO MATCH FURNISHINGS ON W. UNION ST), LOCATE AS INDICATED, SURFACE MOUNT PER MANUFACTURERS RECOMMENDATION
S-104	6' STRAIGHT BENCH, MF2201, BELSON OUTDOORS METAL ARMOR COATED STEEL PARK BENCH, CURVED BACK, WITHOUT CENTER ARM, COLOR: (GREEN/EMERALD; CONTRACTOR TO MATCH W. UNION STREET FURNISHINGS), TO MATCH FURNISHINGS ON W. UNION ST., LOCATE AS INDICATED, SURFACE MOUNT PER MANUFACTURERS RECOMMENDATION
S-105	BIKE RACK, VICTOR STANLEY, BRNS-301, CYCLE SENTRY COLLECTION, (COLOR: GREEN; CONTRACTOR TO MATCH W. UNION STREET FURNISHINGS), CUSTOM MESSAGE 'ATHENS BLOCK' TO MATCH FURNISHINGS ON W. UNION ST., LOCATE AS INDICATED, INGROUND MOUNT PER MANUFACTURERS RECOMMENDATION, SEE DETAIL #2, SHEET L-4

PLANT SCHEDULE

SYMBOL	CODE	BOTANICAL NAME	COMMON NAME	COND.	SIZE	QTY	REMARKS
TREES							
	GP	Ginkgo biloba 'Princeton Sentry'	Princeton Sentry Maidenhair Tree	B&B	2' Cal.	1	
	PL	Platanus x acerifolia 'Liberty'	Liberty London Plane Tree	B&B	2' Cal.	5	
	QM	Quercus macrocarpa	Burr Oak	B&B	2' Cal.	5	
	TG	Tilia cordata 'Greenspire'	Greenspire Littleleaf Linden	B&B	2' Cal.	8	
	UC	Ulmus x 'Frontier'	Frontier Elm	B&B	2' Cal.	2	
	ZG	Zelkova serrata 'Green Vase'	Green Vase Japanese Zelkova	B&B	2' Cal.	11	

REFERENCE NOTES

- Contractor to verify all utility locations in the field prior to beginning work and is responsible for any damage to utilities associated with work. Utilities shall be repaired to satisfaction of the utility owner and/or operating authority at no additional cost.
- In case of discrepancies between the plan and the plant list, the plan shall dictate. Dimensioned details take precedence over scaled details. If in question, contact the landscape architect.
- No substitutions of plant material will be allowed. If plants are shown to be unavailable, the contractor shall notify landscape architect prior to bid date in writing. All plants shall be inspected and tagged with project identification at nursery or contractor's operation prior to moving to job site. Plants may also be inspected and approved or rejected on the job site.
- All disturbed lawn areas shall be seeded or sodded as shown on plans. Refer to erosion control plans for temporary seeding and areas not shown on landscape plans.
- Refer to Civil Site Plan (C200-C202) for all pavement materials and sections.

!! CAUTION !!

THE LOCATIONS OF ALL EXISTING UNDERGROUND UTILITIES SHOWN ON THIS PLAN BASED UPON ABOVE GROUND EVIDENCE (including, but not limited to, manholes, inlets, valves, and marks upon the ground by others) AND ARE SPECULATIVE IN NATURE. THERE MAY ALSO BE OTHER EXISTING UNDERGROUND UTILITIES FOR WHICH THERE IS NO ABOVE GROUND EVIDENCE OR FOR WHICH NO ABOVE GROUND EVIDENCE WAS OBSERVED. THE EXACT LOCATIONS OF SAID EXISTING UNDERGROUND UTILITIES SHALL BE VERIFIED BY THE CONTRACTOR PRIOR TO ANY AND ALL CONSTRUCTION.

CALL TOLL FREE
811 OR 800-362-2764
- OHIO UTILITIES PROTECTION SERVICE -

32 EXTERIOR IMPROVEMENTS SCHEDULE CARPENTER

CODE	DESCRIPTION	DETAIL
32-01	RESIN TREE WELL, 6'X4' LOCATE AND ORIENT AS INDICATED, SEE DETAIL #1 SHEET L-4 FOR MANUFACTURER AND INSTALLATION	

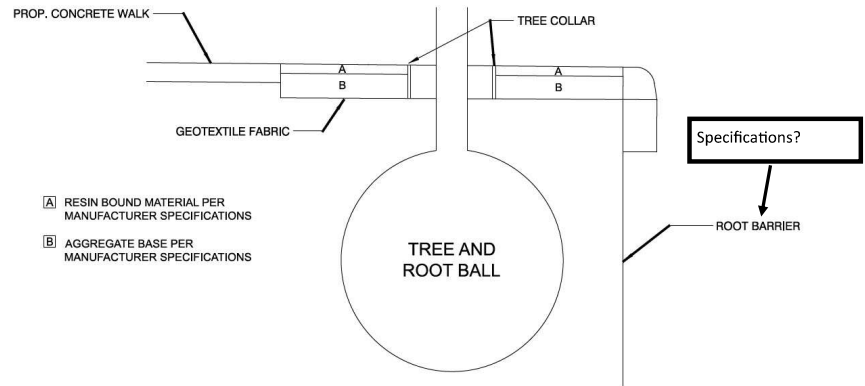

1 RESIN BOUND TREE PIT DETAIL

3/4" = 1'-0"